

Multi-lamp, solid state light engine, recessed linear wall grazer with flanged or flangeless housing. Narrow profile wall grazer used in medium ceiling heights to highlight the texture in surfaces such as stucco or brick, illuminate flat surfaces such as venetian plaster, fabric, wood, or general lighting.

SPECIFICATIONS

HOUSING

- Aluminum housing with integral flange or screed edge for flangeless

MOUNTING

- Recessed in architectural ceiling

ELECTRICAL

- Integral electronic dimmable driver
- 1,699 maximum lumens available

LAMP

- (10) 2.2W, 80 CRI, 2700 thru 4000K LED - supplied with fixture
Consult factory for additional options

SOCKET

- Circuit board mounted to extruded aluminum heatsink

LENS

- Acrylic diffusing lens as standard, narrow and wide beam optics available
- Consult factory for custom options

TRIM

- Overlap flange or flangeless available

FINISH

- Paint on all surfaces in black and white as standard
- Additional colors and RAL palette available
- Consult factory for custom finishes

LABELS

- CSA-C, US, Damp Location

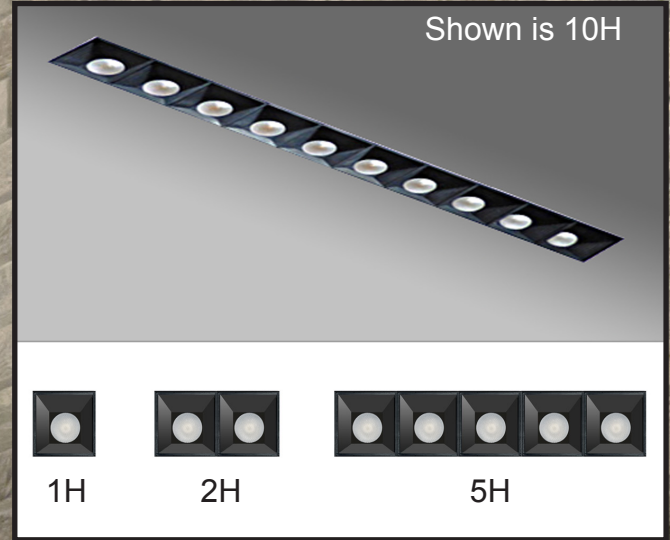

FLANGED



1 Cell



2 Cell



5 Cell



10 Cell

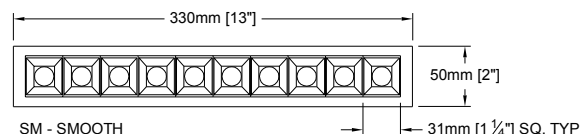
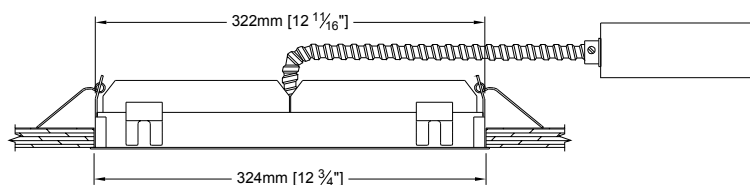
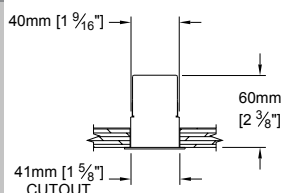

SM - SMOOTH

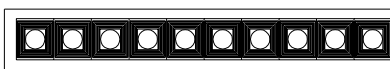

SD - STEP

888-PH

FLANGELESS



1 Cell



2 Cell



5 Cell



10 Cell

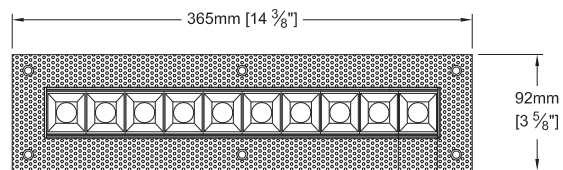
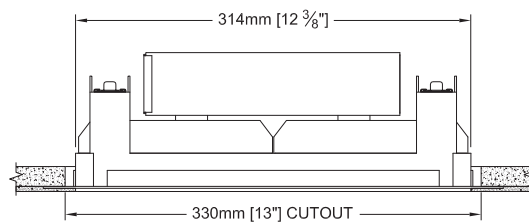
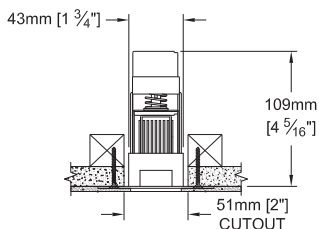

SM - SMOOTH



SD - STEP

ORDERING INFORMATION

888-LED-	CELLS	VOLTAGE	DRIVER	FLANGE/LOUVER	OPTIC	APERTURE LENS
				/		
BAFFLE TYPE SM = Smooth SD = Stepped	1H 2H 5H 10H CST	120 220/240 277 UNV = 120-277	2D = No Dimming 3D = TRIAC /ELV 4D = 0-10v Dimming *CONSULT FACTORY FOR ADDITIONAL OPTIONS	WHT =White / WHT BLK =Black / BLK CST = CST	NW = Narrow WD = Wide	79A = Veiling Acrylic



U.S. Patent D788,968S
These specifications subject to change without notice.

www.specialtylightingindustries.com
1306 Doris Avenue, Ocean, NJ 07712 USA
800.462.7812 732.517.0800 FAX:732.517.0971