

Multi-lamp, solid state light engine, adjustable recessed linear wall grazer with flanged housing. Narrow profile wall grazer used in medium ceiling heights to highlight the texture in surfaces such as stucco or brick, illuminate flat surfaces such as venetian plaster, fabric, wood, or general lighting

## SPECIFICATIONS

### HOUSING

- Aluminum housing with integral flange

### MOUNTING

- Recessed in architectural ceiling

### ELECTRICAL

- Integral electronic dimmable driver
- 5H Cell configuration require Remote driver
- 1,699 maximum lumens available

### LAMP

- (10), 80 CRI, 3000K Standard LED - supplied with fixture
- Consult factory for additional options

### SOCKET

- Circuit board mounted to extruded aluminum heatsink

### LENS

- Acrylic diffusing lens as standard, narrow and wide beam optics available as standard
- Consult factory for custom options

### TRIM

- Overlap flange or flangeless available

### FINISH

- Paint on all surfaces in black and white as standard
- Additional colors and RAL palette available
- Consult factory for custom finishes

### LABELS

-  , US tested to UL standards 1598, Damp location, IC Rated

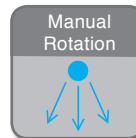

Shown is 5H

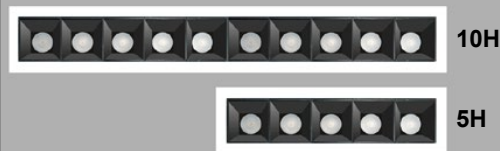
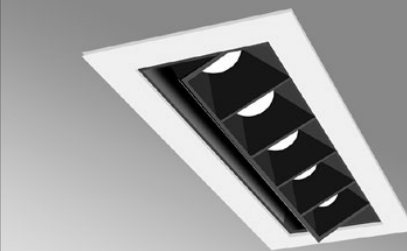

### OUTPUT CHART \*

WIDE (WD)	NARROW (NW)
1306 Lm	1724 Lm
24 w	24 w

\*Based on 10H Configuration

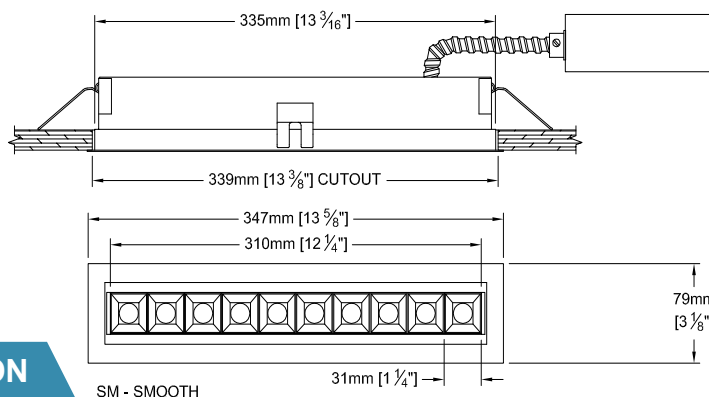
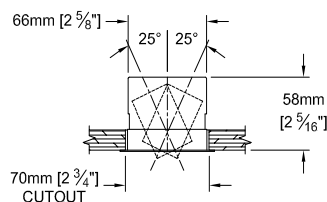

## ORDERING INFORMATION

899-LED-FH	CELLS	VOLTAGE	DRIVER	FLANGE/LOUVER	OPTIC	APERTURE LENS
<b>SM</b>				/		
<b>BAFFLE TYPE</b> SM = Smooth	<b>5H*</b> <b>10H</b> <b>15H</b> <b>CST</b> <small>*Requires Remote Driver</small>	<b>120</b> <b>220/240</b> <b>277</b> UNV = 120-277	<b>2D</b> = No Dimming <b>3D</b> = TRIAC /ELV** <b>4D</b> = 0-10v Dimming <b>RX</b> = remote <small>**120V Only *Consult factory for additional options</small>	<b>WHT</b> =White / WHT <b>BLK</b> =Black / BLK <b>CST</b> = CST	<b>NW</b> = Narrow <b>WD</b> = Wide	<b>79A</b> = Veiling Acrylic