

RECTILINEAR APERTURE RECESSED WALL WASHER

1249WW-2LED-AD-AUH

Dual lamp, solid state light engine, recessed wall washer with 4"x 8" (100mm x 200mm) rectilinear flangeless trim. Wallwashing in medium to tall ceiling heights typically found in residential, commercial and retail applications. Suitable for new construction. Ambient-Dim™ provides Superior CRI at all dimming levels.

SPECIFICATIONS

HOUSING

- Precision die-formed heavy gauge aluminum with extruded ceiling collar
- ≈ Airtight construction suitable for direct contact with insulation

MOUNTING

- Recessed in architectural ceiling

ELECTRICAL

- Integral dimmable electronic driver with internal short circuit protection
- 120v-277v primary, compatible with 0-10v dimmers
- Available for 120v phase control and Lutron

LAMP

- (2) AmbientDim™ LEDs supplied with fixture

SOCKET

- Precision aluminum yoke with CNC machined lampholder assembly
- Usocket™** allows easy field replacement of light engine

LENS

- Frosted Supertex borosilicate spread lens, hinged for relamping

TRIM

- Flangeless, two piece die-cast aluminum pyramidal shield
- ST trim fully sealed and gasketed

FINISH

- Black powder paint housing
- Aperture trim available in black and white as standard
- Solid wood, additional colors, RAL palette, custom finishes available

LABELS

- SP** ^{US}, US tested to UL standards 1598, Damp location, IC/Airtight

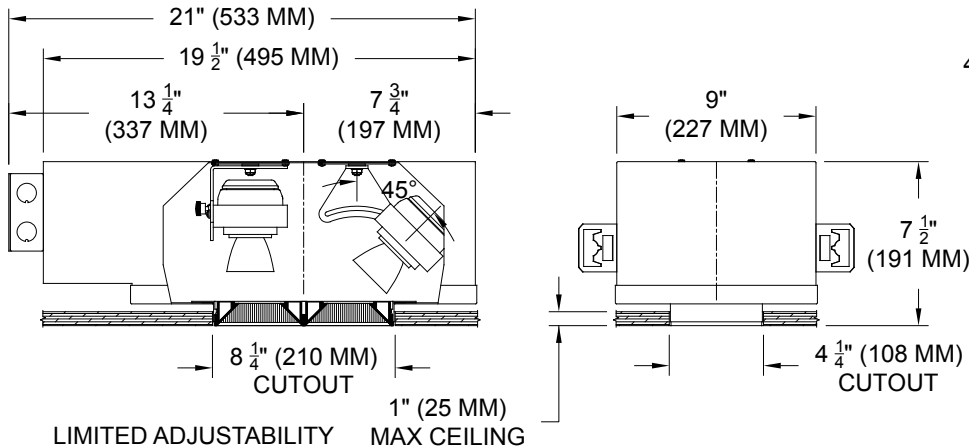

AmbientDim™

REFLECTED PLAN VIEW-C

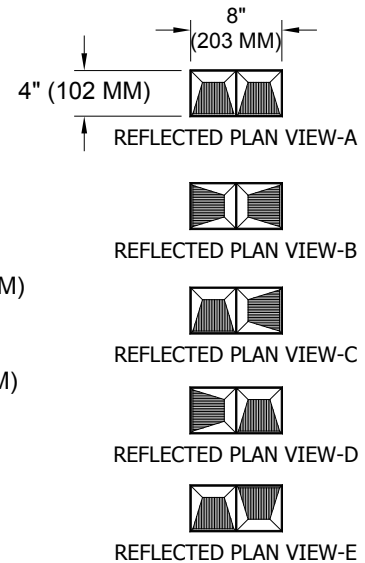
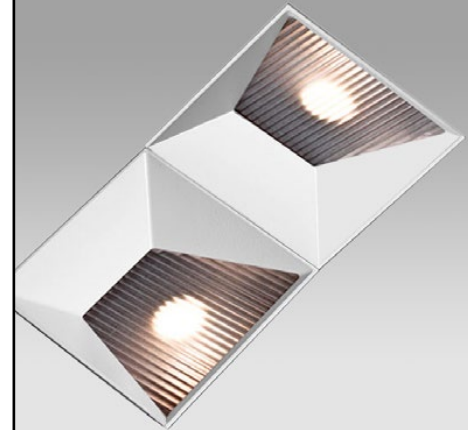

ORDERING INFORMATION

MODEL	PLAN VIEW	TRIM	DRIVER	TRIM FINISH	APERTURE LENS
1249WW-2LED-AD-AUH			AD14		82A
Airtight Universal Housing Ambient Dimming LED *CCT Max 3000K-1900K	WWA = Double WWB = Opposite WWC = Left WWD = Right WWE = Cross	ZT =Zero Trim PT =Panel Trim** **WXX only	AD14 =350ma, 14.5W, 1000lm *Add DM2 for 2 wire dimming *Add LT2 for Lutron 2 wire *Add LT3 for Lutron 3 wire *Add LT5 for Lutron 5 wire *Add LTB for Lutron Fade-to-Black	P14 = White BLK =Black PXX = SLI Color WXX = Wood XXXX = RAL # CST = Custom	82A = Frosted Supertex



Patent Pending.
These specifications subject to change without notice.

www.specialtylightingindustries.com

1306 Doris Avenue, Ocean, NJ 07712 USA

800.462.7812 732.517.0800 FAX:732.517.0971

07/17