

PLASTER CEILING INSTALLATION

1. Secure framing box to existing beams.
2. Install gypsum (sheet rock) ceiling.
3. Connect power supply to fixture housing.
4. Fasten fixture through the plaster frame, and sheet rock and into the framing box.
5. Apply wallboard compound to plaster frame and surrounding sheet rock.
6. Install lamps and test with power.

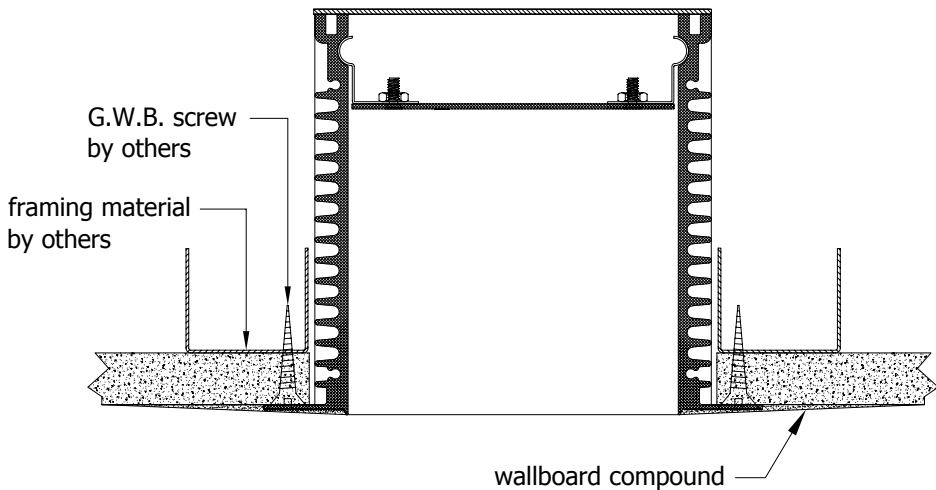

SPECIALTY LIGHTING
INDUSTRIES, INC. © 2004

1306 DORIS AVENUE, OCEAN, NJ 07712 USA

800.462.7812

www.specialtylightingindustries.com

732.517.0800 FAX 732.517.0971

These specifications subject to change without notice.